

WINDSHIELD KIT



P/N 2889405

BEFORE YOU BEGIN

Read these instructions and check to be sure all parts and tools are accounted for. Please retain these installation instructions for future reference and parts ordering information.

APPLICATION

Verify accessory fitment at www.polaris.com.

KIT CONTENTS

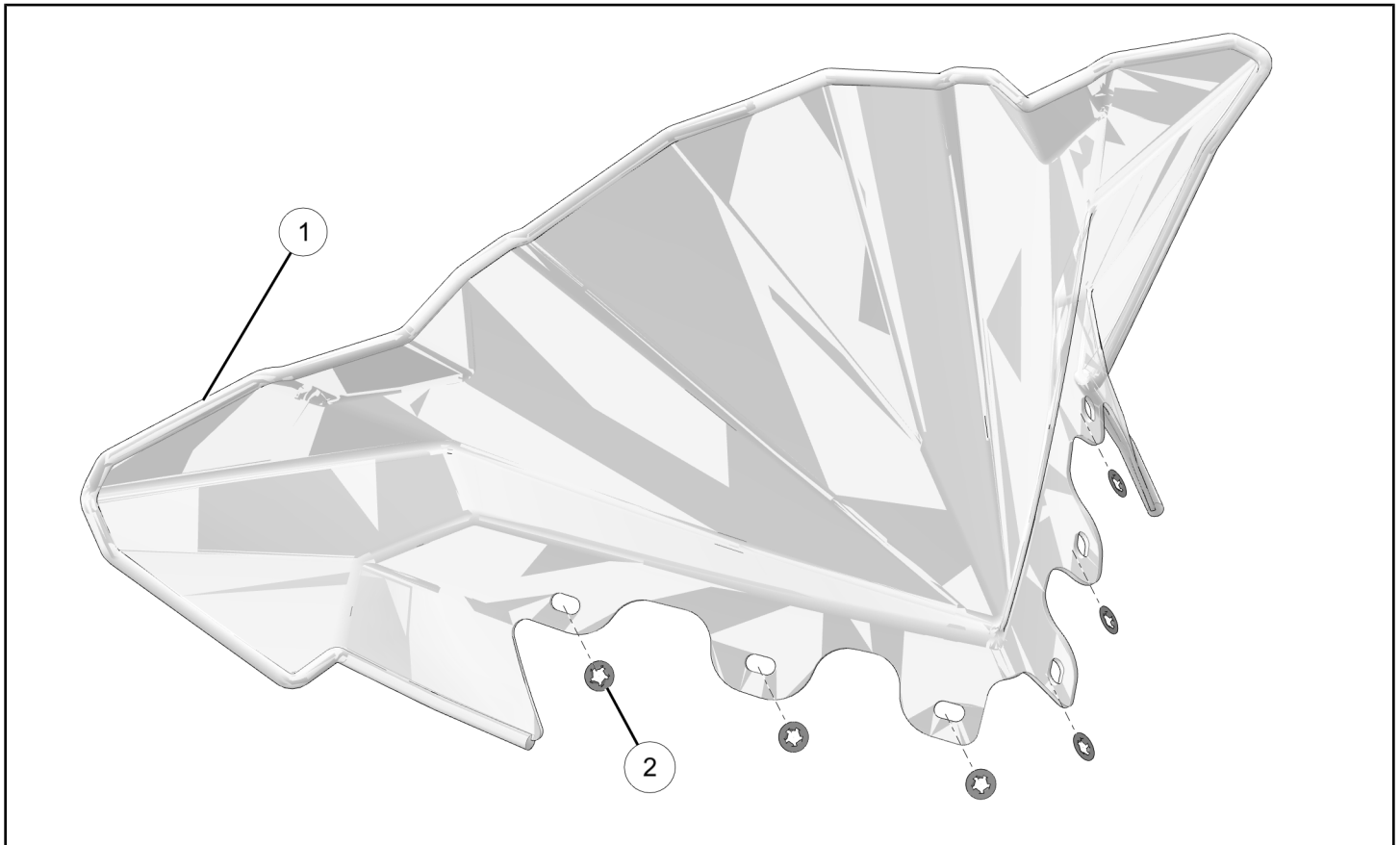

REF	QTY	PART DESCRIPTION	P/N AVAILABLE SEPARATELY
1	1	Windshield	n/a
2	6	Retainer – Bolt, 1/4 - 20	7670154

TOOLS REQUIRED

- Safety Glasses
- Socket Set, Metric

CONSUMABLES REQUIRED

- Cleaning Solution (99% water + 1% mild dishwashing detergent)

IMPORTANT

Your Windshield Kit is exclusively designed for your vehicle. Please read the installation instructions thoroughly before beginning. Installation is easier if the vehicle is clean and free of debris. For your safety, and to ensure a satisfactory installation, perform all installation steps correctly in the sequence shown.

INSTALLATION INSTRUCTIONS

VEHICLE PREPARATION

GENERAL

1. Park vehicle on a flat surface.
2. Push engine stop switch to OFF position.
3. Turn key to OFF position and remove key.
4. Pull sides of windshield retainer away from the vehicle to release tabs, then pull windshield retainer straight out away from the machine.

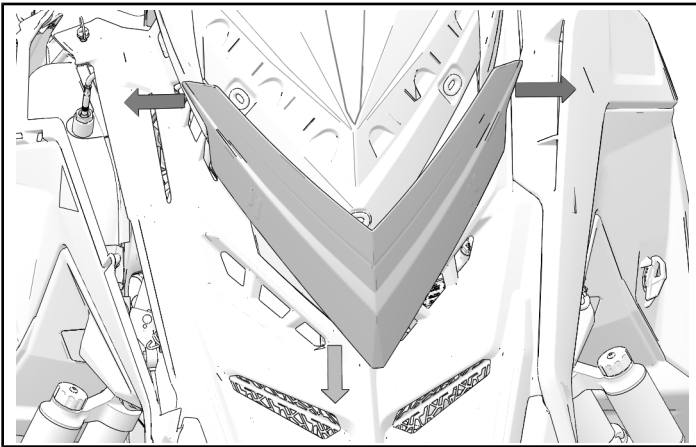

ACCESSORY INSTALLATION

1. Align six molded fasteners on windshield retainer with slots on windshield ①. Put windshield retainer on windshield so that molded fasteners are pushed through slots.

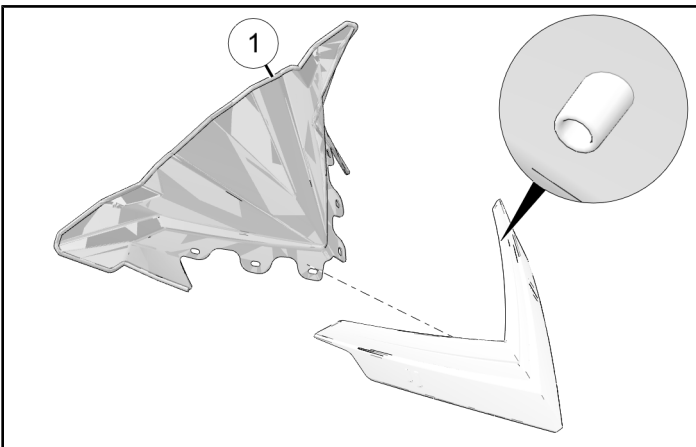

2. Secure windshield to windshield retainer with six push nut retainers ②.

TIP

Use a socket to press on the push nut retainers.

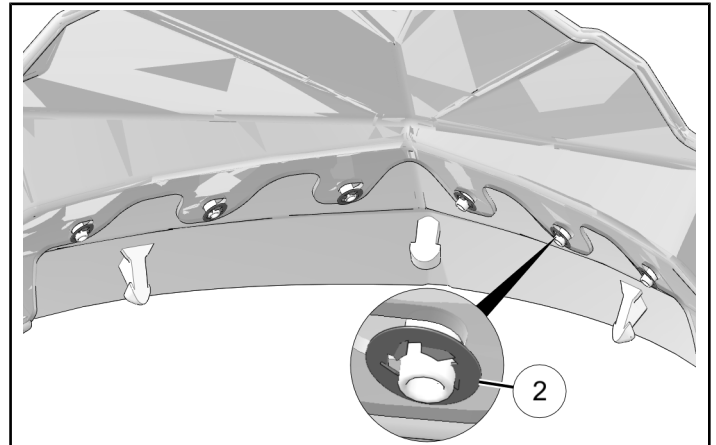

3. Align three mounting tabs on the windshield retainer with three mounting grommets on the hood.

TIP

A small amount of soapy water on the windshield mounting tabs will ease installation.

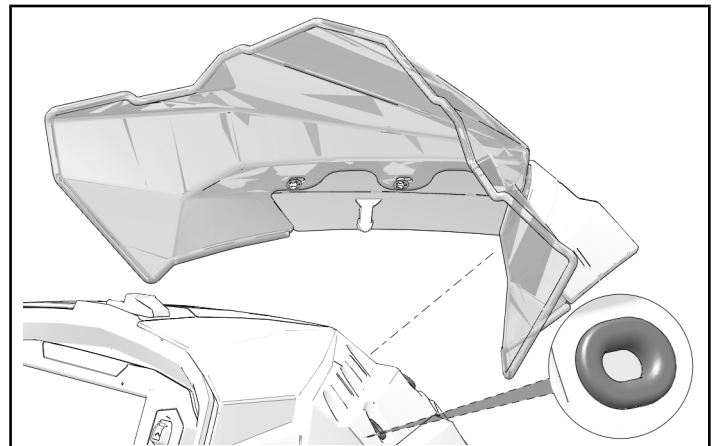

4. Firmly press on first the front, and then the rear, mounting tab locations to make sure windshield is secure.

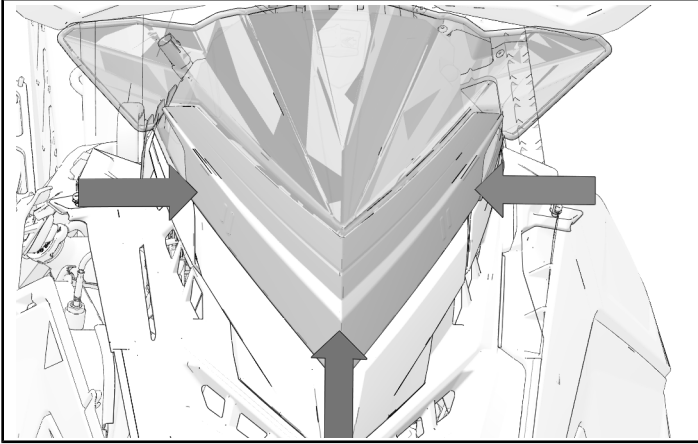

INSTRUCTION FEEDBACK FORM

A feedback form has been created for the installer to provide any comments, questions or concerns about the installation instructions. The form is viewable on mobile devices by scanning the QR code or by clicking [HERE](#) if viewing on a PC.

